



8 Millburn Gardens
, Largs, KA30 9NF

Offers over £149,000



8 Millburn Gardens

, Largs, KA30 9NF

Positioned close to the town centre and sea front, 8 Millburn Gardens is a fantastically spacious two bedroom and two reception room mid terraced villa that will hold broad appeal to many sectors of the market especially with first time buyers and young families. The property is situated on the south side of Largs within a popular residential locale so we strongly advise early viewing to avoid disappointment. The rooms are of excellent proportion and super storage throughout with particular mention to a large floored attic with the potential for a conversion.

The accommodation consists of porch, hall, lounge, separate dining room, kitchen, two double bedrooms, shower room and attic room.

The enclosed back garden is mainly chipped along with some bordering shrubs. There is a communal area of ground behind the private garden. Front garden mainly chipped and on road parking.

EPC = C
COUNCIL TAX BAND = D
GAS CENTRAL HEATING
DOUBLE GLAZING

Porch

6 x 2'7 (1.83m x 0.79m)

Hall

11'5 x 3'7 (3.48m x 1.09m)

Lounge

15 x 11'9 (4.57m x 3.58m)





Dining Room
8'7 x 9'9 (2.62m x 2.97m)

Kitchen
9'7 x 10'6 (2.92m x 3.20m)

Landing
18'7 x 6'6 (5.66m x 1.98m)

Bedroom One
12'6 x 12 (3.81m x 3.66m)

Bedroom Two
10'3 x 10'9 (3.12m x 3.28m)

Shower Room
7'6 x 6'7 (2.29m x 2.01m)

Attic
15'5 x 14'6 (4.70m x 4.42m)

Outside



Floor Plan

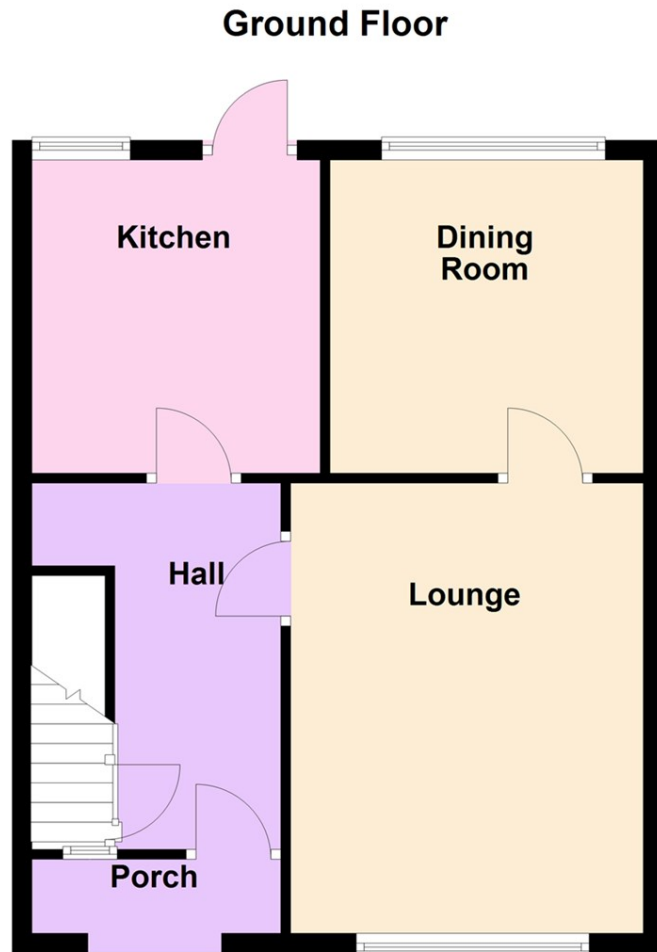

Viewing

Please contact our Largs Office Office on 01475673663 if you wish to arrange a viewing appointment for this property or require further information.

These particulars, whilst believed to be accurate are set out as a general outline only for guidance and do not constitute any part of an offer or contract. Intending purchasers should not rely on them as statements of representation of fact, but must satisfy themselves by inspection or otherwise as to their accuracy. No person in this firms employment has the authority to make or give any representation or warranty in respect of the property.

Area Map



Energy Efficiency Graph

